

ABELL  
SURVEYING & MAPPING

1140 SEQUOIA STREET • DELAVAN, WISCONSIN 53115  
262-728-6737

NOTE: BEARINGS ARE REFERENCED TO THE  
RECORDED SUBDIVISION PLAT.

N



SCALE 1"=30'

LEGEND

- ⊙ - IRON PIPE FOUND
- - UTILITY PEDS.
- WH - WELL HOUSE
- ( ) - RECORDED AS

NOTE: COMMON WELL AGREEMENT AND  
EASEMENTS BETWEEN LOTS 1  
AND 2, BLOCK 6 RECORDED IN  
THE OFFICE OF THE REGISTER  
OF DEEDS FOR WALWORTH COUNTY,  
WISCONSIN.



WELL

LOT 2

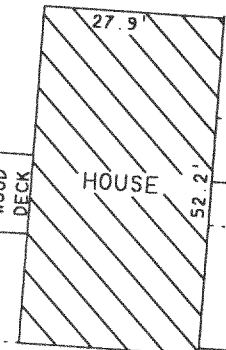

HOUSE

WOOD  
DECK

WOOD DECK  
CONCRETE  
ABOVE

INSPECTION CAP

GRAVEL DRIVE

LOT 1

AREA 0.48 ACRES

VENT PIPES

PLAT OF SURVEY OF

LOTS 1, BLOCK 6, MORaine PARK SUBDIVISION, LOCATED  
IN T4N, R15E, WALWORTH COUNTY, WISCONSIN.

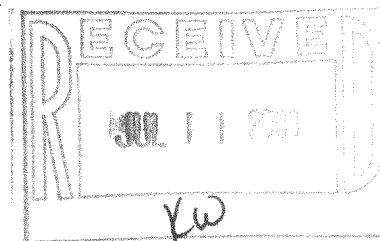

I HEREBY CERTIFY THAT I HAVE SURVEYED THE ABOVE DESCRIBED PROPERTY AND THAT THE  
ABOVE MAP IS A TRUE REPRESENTATION THEREOF AND SHOWS THE SIZE AND LOCATION OF  
THE PROPERTY, ITS EXTERIOR BOUNDARIES, THE LOCATION OF ALL VISIBLE STRUCTURES  
AND DIMENSIONS OF ALL PRINCIPAL BUILDINGS THEREON, BOUNDARY FENCES, APPARENT  
EASEMENTS, ROADWAYS AND VISIBLE ENCROACHMENTS, IF ANY, TO THE BEST OF MY  
KNOWLEDGE AND BELIEF.

THIS SURVEY IS MADE FOR THE USE OF THE PRESENT OWNERS OF THE PROPERTY, AND ALSO  
THOSE WHO PURCHASE, MORTGAGE, OR GUARANTEE THE TITLE THERETO WITHIN ONE (1) YEAR  
FROM DATE HEREON.

David F. Abell

DAVID F. ABELL  
WISCONSIN REGISTERED LAND SURVEYOR, S-1596

ORDERED BY: RE/MAX - HEARTLAND REALTY  
239 E. MILWAUKEE STREET  
WHITEWATER, WI 53190

April 16, 2003

DATE: April 16, 2003 JOB NUMBER - 03043  
NOTE: THIS IS NOT A CERTIFIED COPY UNLESS SEALED.

DMP-60

415-915